

S
388.1
H3p5c
1900

Montana State
Highway
Commission.
Planning Survey
Section coding
procedures and
instructions, 11⁵

PLANNING SURVEY SECTION
CODING PROCEDURES AND INSTRUCTIONS
LOCAL ROAD RURAL INVENTORY
BRIDGES - RAILROADS

STATE DOCUMENTS COLLECTION

JUL 7 1988

MONTANA STATE LIBRARY
2515 E. 6th AVE.
HELENA, MONTANA 59620

PLEASE RETURN

MONTANA STATE LIBRARY

S 398.1 H3psc 1968 c.1

Planning Survey Section coding procedure

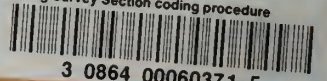

3 0864 00060371 5

JUL 5 1968

CODING PROCEDURES AND INSTRUCTIONS

LOCAL ROAD RURAL INVENTORY

January 1968

COLUMNS 1-2 COUNTY

Code by numerical order of existing alphabetical list all counties in State as set forth by the Bureau of Public Roads.

COLUMNS 3-4-5-6 ROAD NUMBER

Code road number of each road in these columns. Starting from the right.

COLUMNS 7-8-9-10 ACCUMULATED MILEAGE

Code the accumulated mileage of each road in these columns. Always start the first entry of each road with four (4) zeros. On subsequent entries, code accumulated mileage (section lengths).

COLUMNS 11-12 MAP SHEET

Code the map sheet number on which the road appears. Should the road appear on two map sheets, code the number of both sheets. Example: Map sheet 1 and 4, code 14; 5 and 3, code 53, etc.

COLUMNS 13-14 YEAR

Enter the current year the county was reinventoried and each time a road change is made.

COLUMN 15 through 22 LOCATION

Show in these columns by Section, Township, and Range, the starting point of each road.

COLUMNS 23-24 JURISDICTION

Show in these columns who can legally regulate traffic as follows:

01	County	11	Frontage
02	National Forest	12	State Game Preserve
03	National Indian Reservation	13	Private
04	National Park	14	
05	National Monument	15	
06	National Wildlife Refuge	16	
07	Bureau of Land Management	17	
08	State Park	18	
09	State Forest	19	
10	Urban	20	

COLUMNS 25-26 AREA SERVED

Code in these columns the area the road serves as follows:

01	County	10	Urban
02	National Forest	11	Frontage
03	National Indian Reservation	12	State Game Preserve
04	National Park	13	Private
05	National Monument	14	
06	National Wildlife Refuge	15	
07	Bureau of Land Management	16	
08	State Park	17	
09	State Forest	18	

COLUMNS 27-28 RESERVATION OR AREA NAME

Code in these columns the name of each reservation or town the road serves as follows:

When coding towns or cities use the Planning Survey Traffic Section list of town and city codes. For other reservations use the following codes:

NATIONAL FORESTS

65	Beaverhead
66	Bitterroot
67	Coeur d Alene
68	Custer
69	Deerlodge
70	Flathead
71	Gallatin
72	Helena



Digitized by the Internet Archive
in 2012 with funding from
Montana State Library

<http://archive.org/details/planningsurvey7115mont>

National Forests (continued)

73 Kaniksu
 74 Kootenai
 75 Lewis & Clark
 76 Lolo
 77

Indian Reservation

78 Blackfoot
 79 Fort Belknap
 80 Northern Cheyenne
 81 Crow
 82 Flathead
 83 Fort Peck
 84 Rocky Boy

85 Glacier National Park
 86 Yellowstone National Park
 87 National Bison Range
 88 National Monument
 89 National Wildlife Refuge
 90 State Forest
 91 State Park
 92 State Game Preserve
 93
 94
 95
 96
 97
 98
 99
 100

COLUMNS 29-30 F.H. ROUTE NUMBER

Code the appropriate Forest Highway number in these columns (code only Class III F. H. Routes)

COLUMNS 31 through 34 AVERAGE DAILY TRAFFIC

Code traffic figures as supplied.

COLUMNS 35-36 ACCIDENTS

Code total number of accidents for current year as supplied.

COLUMNS 37 through 40 SECTION LENGTH

Code the actual length of each section of road to hundredths. Break at each junction, when entering and leaving a reservation, change in road type or width, bridge and R.R. crossing.

No limit is placed on a section length. It may be one mile or ten miles. This also applies to road length, however, it seems practicable, whenever possible, to contain a road length under 25 miles.

COLUMNS 41-42 ROADWAY WIDTH

Code actual roadway width to the nearest foot. Use minimum of 8' for primitive roads and 10' for bladed roads.

COLUMNS 43-44 SURFACE WIDTH

Code actual surface width to the nearest foot. It is not necessary to code these columns when coding dirt roads.

COLUMNS 45 through 48 SURFACE TYPE

Code the appropriate surface type as follows:

<i>Blue</i>	J — 7201	Portland Cement
<i>Blue</i>	G — 4231	Paved, Road Mix
<i>Blue</i>	F — 3210	Paved, Penetration
<i>Red</i>	E — 2010	Gravel
<i>Green</i>	C — 0010	Graded and Drained
<i>Brown</i>	B — 0002	Bladed
<i>Yellow</i>	A — 0001	Primitive

COLUMNS 49-50 DIRECTION

Show general direction road travels.

COLUMNS 51 through 58 TERMINAL

Show in these columns by Section, Township, and Range, the ending of each road. Also show Section - Township & Range at bridges and railroad crossings.

COLUMNS 59 through 79 REMARKS

Use these columns to show other agency road numbers, area or town names, boundaries, and any other information deemed pertinent.

COLUMN 80 CARD NUMBER

Show in this column which inventory is being coded as follows:

1. Road Inventory
2. Bridge Inventory
3. Railroad Inventory.

GENERAL

DO NOT code Interstate, Primary, or Secondary Roads.

If a road follows a section line on the north or west between counties, code it in the county being inventoried. (CODED)

Code south and east roads in the adjoining county.

Should a reservation road lead outside a reservation code the name of reservation the road belongs to.

Do not code any roads inside an incorporated city.

Code the urban area around a city as county urban and show code for name of city.

Check with supervisor before Xing out roads because of fallen trees, bridge out, wash out, etc.

PLANNING SURVEY SECTION
CODING PROCEDURES AND INSTRUCTIONS
LOCAL BRIDGES RURAL INVENTORY

September 1967

SHOW ALL COLUMNS 1 THROUGH 30 SAME AS ROAD INVENTORY

COLUMN 31 TYPE OF CROSSING (X DENOTES BRIDGES)

Code type of crossing as follows:

0. Highway over water
1. Highway over railroad
2. Highway over highway
3. Highway over waterway and railroad
4. Highway over waterway and highway
5. Highway over railroad and highway
6. Highway under railroad
7. Highway under highway
8. Highway under railroad and highway
9. Use for other combinations such as highway over waterway, railroad and highway, etc.

COLUMN 32 MATERIAL (Substructure) Near Spans

Use this column to identify the material used in the principal supporting span members of the span identified in column 33 as follows:

0. Timber (treated and untreated)
1. Masonry
2. Concrete, not prestressed
3. Steel
4. Steel and concrete
5. Timber and steel
6. Timber and concrete
7. Composite steel and concrete
8. Concrete, prestressed
9. Aluminum

COLUMN 33 TYPE OF BRIDGE

Code the bridge type in this column as follows:

- 0. Slab
- 1. Girder
- 2. Truss (except cantilever)
- 3. Rigid Frame
- 4. Arch
- 5. Cantilever truss
- 6. Movable
- 7. Suspension
- 8. Box Culvert (bridge length)
- 9. Highway Tunnels

COLUMN 34 NUMBER OF SPANS

Code the actual number of near spans.

COLUMN 35-36 LENGTH OF SPANS

Show length to the nearest foot of the longest near span.

COLUMN 37 MATERIAL (Sub-structure) MAIN SPANS

Code as shown in Column 32

COLUMN 38 TYPE OF SPAN

Code as shown in column 33.

COLUMN 39 NUMBER OF SPANS

Code actual number of Main Spans.

COLUMNS 40-41-42 LENGTH OF SPANS

Show length to the nearest foot of the longest Main Span.

COLUMN 43 MATERIAL (Sub-structure) FAR SPANS

Code as shown in column 32.

COLUMN 44 TYPE OF SPAN

Code as shown in column 33.

Local Bridges Rural Inventory

COLUMN 45 NUMBER OF SPANS

-3-

Code actual number of Far Spans.

COLUMNS 46-47 LENGTH OF SPANS

Show length to the nearest foot of the longest Far Span.

COLUMNS 48-49-50 TOTAL LENGTH OF BRIDGE

Show total length of bridge including Near and Far Spans.

COLUMNS 51-52-53 HORIZONTAL CLEARANCE

Code in feet and tenths.

COLUMNS 54 through 61 VERTICAL CLEARANCE

Code vertical clearances (minimum and maximum) in feet and inches.

COLUMNS 62-63 OPENING ABOVE STREAM BED

Show the actual opening from the underside of the bridge deck to the stream bed in feet and tenths.

COLUMN 64 CONDITION OF BRIDGE

Show the general condition of bridge as follows:

1. Excellent
2. Good
3. Fair
4. Poor
5. Critical (unsafe)

COLUMN 65 through 79 REMARKS

Use these columns to show name of feature crossed, load limit, construction year, and other pertinent information.

COLUMN 80 CARD NUMBER

Show which inventory being coded as follows:

1. Road Inventory
2. Bridge Inventory
3. Railroad Inventory

PLANNING SURVEY SECTION
CODING PROCEDURES AND INSTRUCTIONS
LOCAL RAILROAD RURAL INVENTORY

SHOW ALL COLUMNS 1 through 36 SAME AS ROAD INVENTORY

COLUMNS 37 - 38 NAME OF RAILROAD

Show the name of railroad as follows:

- ~~1.~~ Butte, Anaconda and Pacific
- ② Chicago, Burlington and Quincy *BURLINGTON NORTHERN*
- ~~3.~~ Chicago, Milwaukee, St. Paul and Pacific
- ④ ~~Great Northern~~ *BURLINGTON NORTHERN*
- ~~5.~~ Minneapolis, St. Paul and Sault Ste Marie
- ⑥ ~~Montana Western~~ *BURLINGTON NORTHERN*
- ~~7.~~ Montana, Wyoming and Souther
- ⑧ ~~Northern Pacific~~ *BURLINGTON NORTHERN*
- ~~9.~~ Union Pacific
- ~~10.~~ White Sulphur Springs and Yellowstone Park
- 11. *BURLINGTON NORTHERN*
2, 4, 6, 8

COLUMN 39 MAIN TRACKS

Code number of main tracks.

COLUMN 40 OTHER TRACKS

Code number of other tracks.

COLUMNS 41 through 56 DIRECTION OF APPROACH AND PERCENT OF GRADE

Show direction of approach as follows: Code by an X the direction you are traveling as you approach the crossing. Show approach from both directions. Code the percent of grade (100 feet) at both approaches.

COLUMNS 57-58 WARNING SIGNALS (Y denotes R.R Crossings)

Code warning signals as follows:

- 11 Flood lights
- 12 Flashing lights
- 13 Automatic gates
- 14 Automatic barriers
- 15 Manually operated gates
- 16 Miscellaneous, crossbucks, advance warning, etc.
- 17 Rotating stop disk signal
- 18 Flashing light with short arm gate

COLUMNS 59 through 62 SIGHT RESTRICTION

If the railroad crossing is restricted from sight by buildings, trees, etc., place an X in the appropriate quadrant which will show the area restricted as you approach the crossing.

Leave blank if there is no sight restriction.

COLUMNS 63 through 79 REMARKS

These columns may be used to explain the object restricting the sight of the crossing, written name of the railroad or other pertinent information.

COLUMN 80 CARD NUMBER

Show which inventory is being coded as follows:

- 1. Road Inventory
- 2. Bridge Inventory
- 3. Railroad Inventory

0101 APEX	BEAVERHEAD
0102 ARGENTA	BEAVERHEAD
0103 ARMSTEAD	BEAVERHEAD
0104 BANNACK	BEAVERHEAD
0105 BARRATTS	BEAVERHEAD
0106 DELL	BEAVERHEAD
0107 DILLON	BEAVERHEAD
0108 ELKHORN HOT SPRINGS	BEAVERHEAD
0109 GLEN	BEAVERHEAD
0110 GRANT	BEAVERHEAD
0111 GRAYLING	BEAVERHEAD
0112 JACKSON	BEAVERHEAD
0113 LAKEVIEW	BEAVERHEAD
0114 LIMA	BEAVERHEAD
0115 MONIDA	BEAVERHEAD
0116 NAVY	BEAVERHEAD
0117 POLARIS	BEAVERHEAD
0118 RED ROCK	BEAVERHEAD
0119 SNOWLINE	BEAVERHEAD
0120 WISDOM	BEAVERHEAD
0121 WISE RIVER	BEAVERHEAD
0122 US 91 AT IDAHO LINE	BEAVERHEAD
0123 REICHLER	BEAVERHEAD
0130 MONT 43 AT IDAHO LINE	BEAVERHEAD
0131 FAS 324 AT IDAHO LINE	BEAVERHEAD
0132 BIG HOLE BATTLEFIELD	BEAVERHEAD
0133 CLARK CANYON DAM	BEAVERHEAD
0134 PIPE ORGAN LODGE	BEAVERHEAD
0135 KIDD	BEAVERHEAD
0201 ABERDEEN	BIG HORN
0202 BENTEEN	BIG HORN

0203	BUSBY	BIG HORN
0204	CORINTH	BIG HORN
0205	CROW AGENCY	BIG HORN
0206	DECKER	BIG HORN
0207	DUNMORE	BIG HORN
0208	GARRYOWEN	BIG HORN
0209	HARDIN	BIG HORN
0210	KIRBY	BIG HORN
0211	LODGE GRASS	BIG HORN
0212	MCRAE	BIG HORN
0213	PRYOR	BIG HORN
0214	QUIETUS	BIG HORN
0215	ROWLEY	BIG HORN
0216	SAINT XAVIER	BIG HORN
0217	SPEAR	BIG HORN
0218	TOLUCA	BIG HORN
0219	WYOLA	BIG HORN
0220	US 87 AT WYO LINE	BIG HORN
0221	IONIA	BIG HORN
0223	CUSTER BATTLEFIELD	BIG HORN
0232	YELLOWTAIL DAM	BIG HORN
0233	FORT SMITH	BIG HORN
0234	SARPY	BIG HORN
0235	HARDIN SUGAR FACTORY	BIG HORN
0236	TONGUE RIVER DAM	BIG HORN
0301	ADAMS	BLAINE
0302	CHINOOK	BLAINE
0303	COBURG	BLAINE
0304	CLEVELAND	BLAINE
0305	FORT BELKNAP	BLAINE
0306	FORT BELKNAP AGENCY	BLAINE

2

3

0307 HAYS	BLAINE
0308 HARLEM	BLAINE
0309 HOGELAND	BLAINE
0310 LLOYD	BLAINE
0311 LOHMAN	BLAINE
0312 LODGEPOLE	BLAINE
0313 LEROY	BLAINE
0314 MATADOR	BLAINE
0315 NORTH FORK	BLAINE
0316 SAINT PAULS	BLAINE
0317 SAVOY	BLAINE
0318 TURNER	BLAINE
0319 ZURICH	BLAINE
0320 BEAR PAW BATTLEFIELD	BLAINE
0321 FAS 241-PORT OF TREELON	BLAINE
<hr/>	
0401 BARRON	BROADWATER
0402 BREWER	BROADWATER
0403 EUSTIS	BROADWATER
0404 LOMBARD	BROADWATER
0405 PLACER	BROADWATER
0406 RADERSBURG	BROADWATER
0407 TOSTON	BROADWATER
0408 TOWNSEND	BROADWATER
0409 WINSTON	BROADWATER
0420 TOSTON DAM	BROADWATER
0421 CANYON FERRY LAKE	BROADWATER
0422 DIAMOND CITY	BROADWATER
<hr/>	
0501 BEARCREEK	CARBON
0502 BELFRY	CARBON
0503 BRIDGER	CARBON
0504 BOYD	CARBON

W

4

5

0505	EDGAR	CARBON
0506	FROMBERG	CARBON
0507	JOLIET	CARBON
0508	LUTHER	CARBON
0509	MASON	CARBON
0510	ROCKVALE	CARBON
0511	ROBERTS	CARBON
0512	ROSCOE	CARBON
0513	RED LODGE	CARBON
0514	SILESIA	CARBON
0515	WARREN	CARBON
0517	US 310 AT WYO LINE	CARBON
0518	US 212 AT WYO LINE COOKE CITY	CARBON
0519	WASHOE	CARBON
0520	FAS 397 AT WYO LINE	CARBON
0521	BEARTOOTH RESEARCH CAMP	CARBON
0522	ALPINE	CARBON
0523	COONEY DAM	CARBON
0524	BOWLER	CARBON
0525	DRYHEAD	CARBON
0526	SHRIVER	CARBON
0527	ICE CAVES	CARBON
0601	ALBION	CARTER
0602	ALZADA	CARTER
0603	BELLTOWER	CARTER
0604	BOYES	CARTER
0605	CAPITOL	CARTER
0606	EKALAKA	CARTER
0607	HAMMOND	CARTER
0608	MILL IRON	CARTER
0609	RIDGEWAY	CARTER

5

6

0610	US 212 AT WYO LINE ALZADA	CARTER
0611	RIDGE	CARTER
0612	FAS 492 AT WYO LINE	CARTER
0613	MEDICINE ROCKS PARK	CARTER
0614	CHALK BUTTES	CARTER
✓0701	ARMINGTON	CASCADE
0702	ASHUELOT	CASCADE
0703	BELT +	CASCADE
0704	BLACK EAGLE	CASCADE
0705	CASCADE +	CASCADE
0706	EDEN	CASCADE
0707	FIFE	CASCADE
✓0708	FORT SHAW	CASCADE
0709	GERBER	CASCADE
0710	GIFFEN	CASCADE
0711	GOODALE	CASCADE
0712	GORDON	CASCADE
✓0713	GREAT FALLS	CASCADE
✓0714	MONARCH	CASCADE
0715	MORONY DAM	CASCADE
0716	NEIHART +	CASCADE
0717	PORTAGE	CASCADE
0718	RAINBOW DAM	CASCADE
0719	SALEM	CASCADE
✓0720	SUN RIVER	CASCADE
✓0721	STOCKETT	CASCADE
✓0722	SIMMS	CASCADE
✓0723	SANDCOULEE	CASCADE
✓0724	TRACY	CASCADE
✓0725	ULM	CASCADE
✓0726	VAUGHN	CASCADE

0727 VOLTA DAM	CASCADE
0728 INTERNATIONAL AIRPORT GORE FIELD	CASCADE
0759 GREAT FALLS SMELTER	CASCADE
0760 MALMSTROM AIR BASE	CASCADE
0761 GIANT SPRINGS	CASCADE
0762 BENTON LAKE	CASCADE
0763 ADEL	CASCADE
0764 MANCHESTER <i>Big Sky Vista</i>	CASCADE
0765	
0801 BIG SAG	CHOUTEAU
0802 BIG SANDY	CHOUTEAU
0803 CARTER	CHOUTEAU
0804 EAGLETON	CHOUTEAU
0805 FLOWEREE	CHOUTEAU
0806 FORT BENTON	CHOUTEAU
0807 GENOU	CHOUTEAU
0808 GERALDINE	CHOUTEAU
0809 HIGHWOOD	CHOUTEAU
0810 KERSHAW	CHOUTEAU
0811 LIPPARD	CHOUTEAU
0812 LOMA	CHOUTEAU
0813 MONTAGUE	CHOUTEAU
0814 SHONKIN	CHOUTEAU
0815 SQUARE BUTTE	CHOUTEAU
0816 STRANAHAN	CHOUTEAU
0817 TETON	CHOUTEAU
0818 TUNIS	CHOUTEAU
0819 VERONA	CHOUTEAU
0820 VIRGELLE	CHOUTEAU
0821 WALTHAM	CHOUTEAU
0822 WARRICK	CHOUTEAU
0823 RUSSELL	CHOUTEAU

0901 BONFIELD	CUSTER
0902 GARLAND	CUSTER
0903 HORTON	CUSTER
0904 ISMAY	CUSTER
0905 KINSEY	CUSTER
0906 KNOWLTON	CUSTER
0907 LOCATE	CUSTER
0908 MILES CITY	CUSTER
0909 MIZPAH	CUSTER
0910 ONEILL	CUSTER
0911 PARAGON	CUSTER
0912 SHEFFIELD	CUSTER
0913 SHIRLEY	CUSTER
0914 TUSLER	CUSTER
0915 VOLBORG	CUSTER
0916 MILES CITY RADAR BASE	CUSTER
0917 FORT KEOUGH	CUSTER
0918 MILES CITY INDUSTRIAL SCHOOL	CUSTER
<hr/>	
1001 FLAXVILLE	DANIELS
1002 FOUR BUTTES	DANIELS
1003 MADOC	DANIELS
1004 PEERLESS	DANIELS
1005 SCOBAY	DANIELS
1006 WHITETAIL	DANIELS
1007 NAVAJO	DANIELS
1008 FAS 334 PORT OF SCOBAY	DANIELS
1009 MONT 13 WHITETAIL PORT OF ENTRY	DANIELS
<hr/>	
1101 ALLARD	DAWSON
1102 BLOOMFIELD	DAWSON
1103 GLENDIVE	DAWSON
1104 HODGES	DAWSON

1105 LINDSAY	DAWSON
1106 MARSH	DAWSON
1107 RICHEY	DAWSON
1108 RIMROAD	DAWSON
1109 STIPEK	DAWSON
1110 INTAKE	DAWSON
1111 UNION	DAWSON
1112 MAKOSHIKA PARK	DAWSON
1201 ANACONDA	DEER LODGE
1202 BROWN	DEER LODGE
1203 CRACKERVILLE	DEER LODGE
1204 CULLEN	DEER LODGE
1205 GALEN	DEER LODGE
1206 GEORGETOWN LAKE	DEER LODGE
1207 MOREL	DEER LODGE
1208 OPPORTUNITY	DEER LODGE
1209 SILICA	DEER LODGE
1210 SMITHVILLE	DEER LODGE
1211 WARM SPRINGS	DEER LODGE
1212 SOUTHERN CROSS	DEER LODGE
1221 SILVER LAKE	DEER LODGE
1222 STUART	DEER LODGE
1223 ANACONDA WASHOE PARK	DEER LODGE
1224 ANACONDA SMELTER	DEER LODGE
1301 BAKER	FALLON
1302 KNOBS	FALLON
1303 KINGMONT	FALLON
1304 OLLIE	FALLON
1305 PLEVNA	FALLON
1306 WEBSTER	FALLON
1307 WESTMORE	FALLON

12

13

13

1308 WILLARD FALLON

1309 US 12 AT N DAK LINE FALLON

1401 ARMELLS FERGUS

1402 BIG SPRING FERGUS

1403 BECKET FERGUS

1404 BUFFALO FERGUS

1405 BROOKS FERGUS

1406 COFFEE CREEK FERGUS

1407 CHRISTINA FERGUS

1408 DANVERS FERGUS

1409 DENTON FERGUS

1410 DUNLAP FERGUS

1411 FERGUS FERGUS

1412 FORESTGROVE FERGUS

1413 GARNEILL FERGUS

14

1414 GLENGARRY FERGUS

1415 GILTEDGE FERGUS

1416 GRASS RANGE FERGUS

1417 HEATH FERGUS

1418 HILGER FERGUS

1419 HANOVER FERGUS

1420 KINGSTON FERGUS

1421 LEWISTOWN FERGUS

1422 MOORE FERGUS

1423 MOULTON FERGUS

1424 PIPER FERGUS

1425 POWNAL FERGUS

1426 ROSS FORK FERGUS

1427 ROY FERGUS

1428 STRAW FERGUS

1429 SUFFOLK FERGUS

1430	VALENTINE	FERGUS
1431	WARE	FERGUS
1432	WINIFRED	FERGUS
1433	KIPP STATE PARK	FERGUS
1434	FRED ROBINSON BRIDGE	FERGUS
1435	MAIDEN	FERGUS
1436	FORT MAGINNIS	FERGUS
1437	TYLER	FERGUS
1438	LEWISTOWN AIRPORT	FERGUS
1439	PLUM CREEK	FERGUS
1440	EVERSON	FERGUS
1441	CRYSTAL LAKE	FERGUS
1501	BELTON	FLATHEAD
1502	BIG FORK	FLATHEAD
1503	BLACKTAIL	FLATHEAD
1504	COLUMBIA FALLS	FLATHEAD
1505	CORAM	FLATHEAD
1506	CRESTON	FLATHEAD
1507	ESSEX	FLATHEAD
1508	HUNGRY HORSE	FLATHEAD
1509	HALF MOON	FLATHEAD
1510	KILA	FLATHEAD
1511	KALISPELL	FLATHEAD
1512	LUPFER	FLATHEAD
1513	LAKESIDE	FLATHEAD
1514	MARION	FLATHEAD
1515	MCGREGOR LAKE	FLATHEAD
1516	MARTIN CITY	FLATHEAD
1517	NIMROD	FLATHEAD
1518	OLNEY	FLATHEAD
1519	PLEASANT VALLEY	FLATHEAD

14

15

1520	POLEBRIDGE	FLATHEAD
1521	PINNACLE	FLATHEAD
1522	RADNOR	FLATHEAD
1523	RED EAGLE	FLATHEAD
1524	SINGLESHOT	FLATHEAD
1525	SOMMERS	FLATHEAD
1526	SUMMIT	FLATHEAD
1527	SWAN RIVER PO	FLATHEAD
1528	TRAIL CREEK	FLATHEAD
1529	WEST GLACIER	FLATHEAD
1530	WHITEFISH	FLATHEAD
1531	WEST SHORE STATE PARK	FLATHEAD
1532	NYACK	FLATHEAD
1533	LAKE FIVE	FLATHEAD
1534	SPOTTED BEAR RANGER STATION	FLATHEAD
1535	WHITEFISH LAKE	FLATHEAD
1536	BIG MOUNTAIN	FLATHEAD
1537	WHITEFISH COUNTRY CLUB	FLATHEAD
1538	ACM ALUMINUM PLANT	FLATHEAD
1539	FLATHEAD CO. AIRPORT	FLATHEAD
1540	LA SALLE	FLATHEAD
1541	LAKE BLAINE	FLATHEAD
1542	HIDDEN LAKE	FLATHEAD
1543	ASHLEY LAKE	FLATHEAD
1544	FOY LAKE	FLATHEAD
1545	FLATHEAD LAKE	FLATHEAD
1546	COLUMBIA HEIGHTS	FLATHEAD
1547	STATE SOLDIERS HOME	FLATHEAD
1548	APGAR	
1601	ACCOLA	GALLATIN
1602	AMSTERDAM	GALLATIN
1603	ANCENEY	GALLATIN

15

16

1604	ATKINS	GALLATIN
1605	ARNOLD	GALLATIN
1606	BELGRADE	GALLATIN
1607	BOZEMAN	GALLATIN
1608	BOZEMAN HOT SPRINGS	GALLATIN
1609	BLACK WOOD	GALLATIN
1610	CENTRAL PARK	GALLATIN
1611	CLARKSTON	GALLATIN
1612	CARPENTER	GALLATIN
1613	CHURCHILL	GALLATIN
1614	DEER PARK	GALLATIN
1615	EDILOW	GALLATIN
1616	FRANCIS	GALLATIN
1617	GALLATIN GATEWAY	GALLATIN
1618	GREEN WOOD	GALLATIN
1619	GRAYLING	GALLATIN
1620	HEBGEN DAM	GALLATIN
1621	HOLLAND	GALLATIN
1622	KARST KAMP	GALLATIN
1623	LOGAN	GALLATIN
1624	MANHATTAN	GALLATIN
1625	MAUDLOW	GALLATIN
1626	MATHEWS	GALLATIN
1627	MENARD	GALLATIN
1628	NATHAN	GALLATIN
1629	POTTER	GALLATIN
1630	PATTERSON	GALLATIN
1631	SAPPINGTON	GALLATIN
1632	SPRINGHILL	GALLATIN
1633	STORY	GALLATIN
1634	WEST END	GALLATIN

16

1635 WILLOW CREEK	GALLATIN
1636 WALRATH	GALLATIN
1637 WEST YELLOWSTONE	GALLATIN
1638 US 191 & US 20 AT IDAHO LINE	GALLATIN
1639 THREE FORKS	GALLATIN
1640 TRIDENT	GALLATIN
1641 US 191 AT YELLOWSTONE PARK LINE	GALLATIN
1675 BELGRADE SAWMILL	GALLATIN
1682 BOZEMAN FISH HATCHERY	GALLATIN
1683 GALLATIN COUNTY AIRPORT	GALLATIN
1701 BENZIEN	GARFIELD
1702 BRUSETT	GARFIELD
1703 COHAGEN	GARFIELD
1704 EDWARDS	GARFIELD
1705 HAXBY	GARFIELD
1706 HILLSIDE	GARFIELD
1707 JORDAN	GARFIELD
1708 MECAHA	GARFIELD
1709 MOSBY	GARFIELD
1710 SAND SPRINGS	GARFIELD
1711 VAN NORMAN	GARFIELD
1712 BUTTE CREEK	GARFIELD
1713 ROCK CREEK STATE PARK	GARFIELD
1714 HELL CREEK STATE PARK	GARFIELD
1715 FLOWING WELL CAMP	GARFIELD
1801 BABB	GLACIER
1802 BALTIC	GLACIER
1803 BISON	GLACIER
1804 BLACKFOOT	GLACIER
1805 BROWNING	GLACIER
1806 CUT BANK	GLACIER

16

17

18

1807 EAST GLACIER GLACIER
1808 FORT PIEGAN GLACIER
1809 GUN SIGHT GLACIER
1811 MERIWEATHER GLACIER
1812 CUT BANK RADAR BASE GLACIER
1813 RISING WOLF GLACIER
1814 SANTA RITA GLACIER
1815 SPOTTED ROBE GLACIER
1816 SUN DANCE GLACIER
1817 SAINT MARYS GLACIER
1818 TRIPLE DIVIDE GLACIER
1819 MONT 17 PORT OF CHIEF MTN GLACIER
1820 US 89 PORT OF BABB GLACIER
1821 KIOWA JCT GLACIER
1822 DUCK LAKE GLACIER
1862 CUT BANK AIRPORT GLACIER
1863 FAS 483 PORT OF DEL BONITA GLACIER

1901 BARBER GOLDEN VALLEY
1902 BELMONT GOLDEN VALLEY
1903 BURGOYNE GOLDEN VALLEY
1904 CUSHMAN GOLDEN VALLEY
1905 FRANKLIN GOLDEN VALLEY
1906 LAVINA GOLDEN VALLEY
1907 PAINTED ROBE GOLDEN VALLEY
1908 ROTHIMAY GOLDEN VALLEY
1909 RYEGATE GOLDEN VALLEY
1910 SLAYTON GOLDEN VALLEY
1911 WALLUM GOLDEN VALLEY
1912 EMORY GOLDEN VALLEY

2001 BEARMOUTH GRANITE
2002 DRUMMOND GRANITE

2003 HALL	GRANITE
2004 HASKELL	GRANITE
2005 MAXVILLE	GRANITE
2006 NIMROD	GRANITE
2007 OZAN	GRANITE
2008 PHILIPSBURG	GRANITE
2009 PORTERS CORNER	GRANITE
2010 RAVENNA	GRANITE
2011 WILLIS	GRANITE
2012 GARNETT	GRANITE
2013 SKALKAHO PASS	GRANITE
2014 ECHO LAKE	GRANITE
2101 NORTH MONT EXPERIMENTAL STATION	HILL
2102 BOX ELDER	HILL
2103 BURNHAM	HILL
2104 FRESNO	HILL
2105 GILFORD	HILL
2106 GOLDSTONE	HILL
2107 HAVRE	HILL
2108 HINGHAM	HILL
2109 INVERNESS	HILL
2110 KREMLIN	HILL
2111 LAREDO	HILL
2112 PACIFIC JCT	HILL
2113 ROCKY BOY	HILL
2114 RUDYARD	HILL
2115 SIMPSON	HILL
2116 SHAMBO	HILL
2117 FAS 233-PORT OF WILLOW CREEK	HILL
2118 FAS 232-PORT OF WILD HORSE	HILL
2121 HAVRE RADAR BASE	HILL

20

21

2136	FRESNO LAKE	HILL
2137	HAVRE COUNTRY CLUB	HILL
2138	HAVRE AIRPORT	HILL
2139	BEAVER CREEK PARK	HILL
2201	ALHAMBRA	JEFFERSON
2202	AMAZON	JEFFERSON
2203	BASIN	JEFFERSON
2204	BERNICE	JEFFERSON
2205	BOULDER	JEFFERSON
2206	CARDWELL	JEFFERSON
2207	CLANCY	JEFFERSON
2208	CORBIN	JEFFERSON
2209	DONALD	JEFFERSON
2210	ELK PARK	JEFFERSON
2211	FULLER	JEFFERSON
2212	HOMESTAKE	JEFFERSON
2213	JEFFERSON CITY	JEFFERSON
2214	LEWIS & CLARK CAVERN	JEFFERSON
2215	MONTANA CITY	JEFFERSON
2216	PIEDMONT	JEFFERSON
2217	PIPESTONE HOT SPRINGS	JEFFERSON
2218	TRASK	JEFFERSON
2219	WICKES	JEFFERSON
2220	WHITEHALL	JEFFERSON
2221	WOODVILLE	JEFFERSON
2222	LAHOOD	JEFFERSON
2223	MILLIGAN CANYON	JEFFERSON
2224	CLASOIL	JEFFERSON
2230	DIAMOND S RANCH	JEFFERSON
2231	BOULDER STATE TRAINING SCHOOL	JEFFERSON
2232	CRYSTAL CREEK CAMP	JEFFERSON

21

22

22

2233 TIZER LAKES

JEFFERSON

2234 CEDRIC

JEFFERSON

2235 VENDOME

JEFFERSON

2236 PORTAL

JEFFERSON

2301 ARROW CREEK

JUDITH BASIN

2302 BARROWS

JUDITH BASIN

2303 BENCHLAND

JUDITH BASIN

2304 DOVER

JUDITH BASIN

2305 GEYSER

JUDITH BASIN

2306 HAUCK

JUDITH BASIN

2307 HOBSON

JUDITH BASIN

2308 KOLIN

JUDITH BASIN

2309 MERINO

JUDITH BASIN

2310 MOCCASIN

JUDITH BASIN

23

2311 RAYNESFORD

JUDITH BASIN

2312 SIPPLE

JUDITH BASIN

2313 SPION KOP

JUDITH BASIN

2314 STANFORD

JUDITH BASIN

2315 UTICA

JUDITH BASIN

2316 WINDHAM

JUDITH BASIN

2317 LEHIGH

JUDITH BASIN

2318 HUGHESVILLE

JUDITH BASIN

2319 ACKLEY LAKE

JUDITH BASIN

2320 CENTRAL MONT EXPERIMENTAL STATION

JUDITH BASIN

2401 ARLEE

LAKE

2402 BIGARM

LAKE

2403 CHARLO

LAKE

24

2404 DAYTON

LAKE

2405 ELMO

LAKE

2406 KERR DAM

LAKE

2407 MOIESE

LAKE

2408	PROCTOR	LAKE	
2409	POLSON	LAKE	
2410	PABLO	LAKE	
2411	RAVALLI	LAKE	
2412	ROLLINS	LAKE	
2413	RADIO	LAKE	
2414	RONAN	LAKE	
2415	ROUND BUTTE	LAKE	
24	2416 SAINT IGNATIUS	LAKE	
	2417 SWAN LAKE	LAKE	
	2418 LAKE MARY RONAN	LAKE	
	2419 YELLOW BAY STATE PARK	LAKE	
	2420 FINLEY POINT	LAKE	
	2421 BLUE BAY	LAKE	
	2422 U OF M BIOLOGICAL STATION	LAKE	
	2423 NINE PIPE BIRD REFUGE	LAKE	
✓	2501 AUGUSTA +	LEWIS	CLARK
	2502 AUSTIN	LEWIS	CLARK
	2503 BIRDSEYE	LEWIS	CLARK
	2504 CANYON CREEK	LEWIS	CLARK
✓	2505 CRAIG	LEWIS	CLARK
	2506 CANYON FERRY	LEWIS	CLARK
o	2507 EAST HELENA	LEWIS	CLARK
25	2508 FORT HARRISON	LEWIS	CLARK
✓	2509 GILMAN	LEWIS	CLARK
	2510 HAUSER DAM	LEWIS	CLARK
o	2511 HELENA	LEWIS	CLARK
	2512 HOLTER DAM	LEWIS	CLARK
	2513 LINCOLN +	LEWIS	CLARK
	2514 MARYSVILLE	LEWIS	CLARK
	2515 MCDONALD PASS	LEWIS	CLARK

2516	NELSON	LEWIS	CLARK
2517	RIMINI	LEWIS	CLARK
2518	SEAVER PARK	LEWIS	CLARK
2519	SIEBEN	LEWIS	CLARK
2520	SILVER CITY	LEWIS	CLARK
2521	UNIONVILLE	LEWIS	CLARK
2522	WILBORN	LEWIS	CLARK
2523	WOLF CREEK	LEWIS	CLARK
2524	YORK	LEWIS	CLARK
2525	HELENA FAIR GROUNDS	LEWIS	CLARK
2529	GATES OF THE MOUNTAINS	LEWIS	CLARK
2530	BOWMANS CORNER	LEWIS	CLARK
2531	ROGERS PASS	LEWIS	CLARK
2532	BEAN LAKE	LEWIS	CLARK
2533	STEMPLE PASS	LEWIS	CLARK
2534	FLESHER PASS	LEWIS	CLARK
2535	BELMONT SKI AREA	LEWIS	CLARK
2536	LAKE HELENA	LEWIS	CLARK
2537	EHLERS CORNER	LEWIS	CLARK
2538	LAKESIDE	LEWIS	CLARK
2539	MAGPIE GULCH	LEWIS	CLARK
2540	HELENA AIRPORT	LEWIS	CLARK
2541	COLORADO GULCH	LEWIS	CLARK
2542	VANDEBURG VILLAGE	LEWIS	CLARK
2543	BROADWATER	LEWIS	CLARK
2544	HELENA STATE NURSERY	LEWIS	CLARK
2545	HELENA COUNTRY CLUB	LEWIS	CLARK
2601	BUELOW	LIBERTY	
2602	CHESTER	LIBERTY	
2603	HILL	LIBERTY	
2604	JOPLIN	LIBERTY	

25

26

* SEE REVERSE SIDE FOR ADDITIONS TO LEWIS & CLARK.

2605	LOTHAIR	LIBERTY
2606	TIBER	LIBERTY
2607	TIBER DAM	LIBERTY
2608	WHITLASH	LIBERTY
2701	EUREKA	LINCOLN
2702	FORTINE	LINCOLN
2703	HAPPYS INN	LINCOLN
2704	LIBBY	LINCOLN
2705	REXFORD	LINCOLN
2706	RIPLEY	LINCOLN
2707	STONEHILL	LINCOLN
2708	STRYKER	LINCOLN
2709	TREGO	LINCOLN
2710	TOBACCO	LINCOLN
2711	TROY	LINCOLN
2712	URAL	LINCOLN
2713	WARLAND	LINCOLN
2714	YAAK	LINCOLN
2715	YAKT	LINCOLN
2716	YARNELL	LINCOLN
2717	US 93 PORT OF ROOSVILLE	LINCOLN
2718	US 2 AT IDAHO LINE	LINCOLN
2719	JENNINGS	LINCOLN
2720	TROY RADAR BASE	LINCOLN
2721	CO RD PORT OF GATEWAY	LINCOLN
2722	SAVAGE LAKE	LINCOLN
2723	LIBBY FISH HATCHERY	LINCOLN
2724	LIBBY ZONOLITE PLANT	LINCOLN
2725	BULL LAKE	LINCOLN
2801	BROCKWAY	MCCONE
2802	CIRCLE	MCCONE

26

27

28

28

2803 FORT PECK DAM	MCCONE
2804 PRESSERVILLE	MCCONE
2805 VIDA	MCCONE
2806 WATKINS	MCCONE
2807 WELDON	MCCONE

29

2901 ALDER	MADISON
2902 BROWNS	MADISON
2903 BEALS	MADISON
2904 CAMERON	MADISON
2905 CLIFFLAKE	MADISON
2906 ENNIS	MADISON
2907 HARRISON	MADISON
2908 IRON ROD	MADISON
2909 JEFFERSON ISL	MADISON
2910 JEFFERS	MADISON
2911 LAURIN	MADISON
2912 MCALLISTER	MADISON
2913 NORRIS	MADISON
2914 PONY	MADISON
2915 SHERIDAN	MADISON
2916 SILVER STAR	MADISON
2917 TWIN BRIDGES	MADISON
2918 VARNEY	MADISON
2919 VIRGINIA CITY	MADISON
2920 WATERLOO	MADISON
2921 WATKINS	MADISON
2922 MONT 287 AT IDAHO LINE	MADISON
2923 QUAKE LAKE	MADISON
2924 TWIN BRIDGES ORPHANS HOME	MADISON
2925 WILLOW CREEK RESERVOIR	MADISON
2926 RUBY RIVER DAM	MADISON

29
2927 ENNIS LAKE MADISON
2928 POTOSI HOT SPRINGS MADISON
2929 ZIEGLER HOT SPRINGS MADISON
2930 HUTCHINS RANCH MADISON

3001 CHECKERBOARD MEAGHER
3002 FORT LOGAN MEAGHER
3003 GROVELAND MEAGHER
3004 LENNEP MEAGHER
3005 LOWETH MEAGHER
3006 LINGSHIRE MEAGHER
3007 MARTINSDALE MEAGHER
3008 RINGLING MEAGHER
3009 SIXTEEN MEAGHER
3010 WATSON MEAGHER
3011 WHITE SULPHUR SPRINGS MEAGHER

30
3012 THALE MEAGHER
3013 DOUGLAS SAW MILL MEAGHER
3014 B&K SAW MILL MEAGHER
3015 ROACH SAW MILL MEAGHER
3023 BRUNO MEAGHER
3024 BARZEE MEAGHER
3025 KINGS HILL MEAGHER
3026 SMITH RIVER RESERVOIR MEAGHER
3027 DURAND RESERVOIR MEAGHER

31
3101 ALBERTON MINERAL
3102 ASHMORE MINERAL
3103 BORAX MINERAL
3104 BRYSON MINERAL
3105 COBDEN MINERAL
3106 CYR MINERAL
3107 DEBORGIA MINERAL

3108	DREXEL	MINERAL
3109	EAST PORTAL	MINERAL
3110	FORAKER	MINERAL
3111	HAUGAN	MINERAL
3112	HENDERSON	MINERAL
3113	LOUZEAU	MINERAL
3114	PLATEAU	MINERAL
3115	RIVULET	MINERAL
3116	SALTESE	MINERAL
3117	SPRING GULCH	MINERAL
3118	SUPERIOR	MINERAL
3119	SOHON	MINERAL
3120	SAINT REGIS	MINERAL
3121	TARKIO	MINERAL
3122	TOOLE	MINERAL
3123	WESTFALL	MINERAL
3124	US 10 AT IDAHO LINE	MINERAL
3125	IRON MOUNTAIN	MINERAL
3126	CAMELS HUMP	MINERAL
3127	SAVENAC NURSERY	MINERAL
3128	FOREST GROVE	MINERAL
3129	DIAMOND MATCH CO	MINERAL
3201	BONNER	MISSOULA
3202	BONITA	MISSOULA
3203	CONDON	MISSOULA
3204	CARLTON	MISSOULA
3205	CLINTON	MISSOULA
3206	DESMET	MISSOULA
3207	EVARO	MISSOULA
3208	FRENCHTOWN	MISSOULA
3209	FINNTOWN Pinegrove	MISSOULA

31

32

3210 GREENOUGH	MISSOULA
3211 HUSON	MISSOULA
3212 IRIS	MISSOULA
3213 LOLO	MISSOULA
3214 LOLO HOT SPRINGS	MISSOULA
3215 LOTHROP	MISSOULA
3216 MILLTOWN	MISSOULA
3217 MISSOULA	MISSOULA
3218 NINE MILE	MISSOULA
3219 NAGOS	MISSOULA
3220 POTOMAC	MISSOULA
3221 PILTZVILLE	MISSOULA
3222 POST	MISSOULA
3223 SOUDAN	MISSOULA
3224 STARK	MISSOULA
3225 SCHLEY	MISSOULA
3226 SEELEY LAKE	MISSOULA
3227 SUNSET	MISSOULA
3228 WEST RIVERSIDE	MISSOULA
3229 WOODMAN	MISSOULA
3230 FAS 412 AT IDAHO LINE	MISSOULA
3231 PRIMROSE	MISSOULA
3232 US SMOKE JUMPERS SCHOOL	MISSOULA
3233 MISSOULA AIRPORT	MISSOULA
3234 SALMON LAKE	MISSOULA
3235 PLACID LAKE	MISSOULA
3236 FORT MISSOULA	MISSOULA
3237 EAST MISSOULA	MISSOULA
3238 ORCHARD HOMES	MISSOULA
3239 MISSOULA COUNTRY CLUB	MISSOULA
3301 BUNDY	MUSSELSHELL

32

33

SEE REVERSE SIDE FOR ADDITIONS TO MISSOULA County

01 2nd ✓
3302 DELPHIA ✓

MUSSELSHELL

3303 ELSO ✓

MUSSELSHELL

3304 GAGE ✓

MUSSELSHELL

3305 KLEIN ✓

MUSSELSHELL

3306 KEANE ✓

MUSSELSHELL

3307 MELSTONE ✓

MUSSELSHELL

3308 MUSSELSHELL ✓

MUSSELSHELL

3309 ROUNDUP ✓

MUSSELSHELL

3401 BRISBIN

PARK

3402 CHICORY

PARK

3403 CLYDE PARK

PARK

3404 CARBELLA

PARK

3405 CORWIN SPRINGS

PARK

3406 COOKE CITY

PARK

3407 DOLLEY

PARK

3408 DEEVER

PARK

3409 ELTON

PARK

3410 EMIGRANT

PARK

3411 GARDINER

PARK

3412 HOPPERS

PARK

3413 JARDINE

PARK

3414 LIVINGSTON

PARK

3415 MINER

PARK

3416 MERRIMAN

PARK

3417 MISSION

PARK

3418 MUIR

PARK

3419 PRAY

PARK

3420 SILVER GATE

PARK

3421 SPHINX

PARK

3422 SPRINGDALE

PARK

3423 WILSALL

PARK

3424	US 89 AT YELLOWSTONE PARK	PARK
3425	CHICO HOT SPRINGS	PARK
3426	PINE CREEK REC AREA	PARK
3427	SWINGLEY	PARK
3428	LIVINGSTON AIRPORT	PARK
3429	DAILEY	PARK
3430	MONTANAPOLIS SPRINGS	PARK
3431	HUNTERS HOT SPRINGS	PARK
3501	CAT CREEK	PETROLEUM
3502	FLAT WILLOW	PETROLEUM
3503	TEIGAN	PETROLEUM
3504	WINNETT	PETROLEUM
3505	BLAKESLEE	PETROLEUM
3506	KELLEY	PETROLEUM
3507	WAR HORSE LAKE	PETROLEUM
3508	WILD HORSE LAKE	PETROLEUM
3509	YELLOW WATER DAM	PETROLEUM
3601	BOWDOIN	PHILLIPS
3602	CHAPMAN	PHILLIPS
3603	CONTENT	PHILLIPS
3604	DODSON	PHILLIPS
3605	LANDUSKY	PHILLIPS
3606	LORING	PHILLIPS
3607	LOWRANE	PHILLIPS
3608	MALTA	PHILLIPS
3609	PHILLIPS	PHILLIPS
3610	REGINA	PHILLIPS
3611	SACO	PHILLIPS
3612	STRATER	PHILLIPS
3613	TELEGRAPH CR	PHILLIPS
3614	WAGNER	PHILLIPS

3615 WHITE WATER PHILLIPS
3616 ZORTMAN PHILLIPS
3617 FAS 242 PORT OF MORGAN PHILLIPS
3618 SACO HOT SPRINGS PHILLIPS
3619 LAKE BOWDOIN PHILLIPS
3620 NELSON RESERVOIR PHILLIPS
3621 HORSE SHOE LAKE PHILLIPS
3622 COLE PHILLIPS

3701 BRADY PONDERA
3702 CONRAD PONDERA
✓ 3703 DUPUYER PONDERA
✓ 3704 HEART BUTTE PONDERA
↓ 3705 LEDGER PONDERA

3706 MANSON PONDERA
3707 PERSHING PONDERA
✓ 3708 VALIER PONDERA
✓ 3709 WILLIAMS PONDERA
3710 LAKE FRANCES PONDERA
↓ 3711 FOWLER PONDERA
3712 GALLUP CITY PONDERA

3801 BAY HORSE POWDER RIVER
3802 BIDDLE POWDER RIVER
3803 BOWERS POWDER RIVER
3804 BROADUS POWDER RIVER
3805 CAMPS PASS POWDER RIVER
3806 COALWOOD POWDER RIVER
3807 EPSIE POWDER RIVER
3808 MOORHEAD POWDER RIVER
3809 OLIVE POWDER RIVER
3810 OTTER POWDER RIVER
3811 POWDERVILLE POWDER RIVER

38

3812 RANCHCREEK	POWDER RIVER
3813 SAYLE	POWDER RIVER
3814 SONNETTE	POWDER RIVER
3815 STACEY	POWDER RIVER
3816 LOESCH	POWDER RIVER
3817 FAS 319 AT WYOMING LINE	POWDER RIVER
3818 OLD FORT HOWE	POWDER RIVER

3819 Bell creek

39

3901 AVON	POWELL
3902 BLOSSBURG	POWELL
3903 BRADLEY	POWELL
3904 COTTONWOOD	POWELL
3905 DEER LODGE	POWELL
3906 DEMPSEY	POWELL
3907 ELLISTON	POWELL
3908 FINN	POWELL
3909 GARRISON	POWELL
3910 GOLD CREEK	POWELL
3911 HELMVILLE	POWELL
3912 JENS	POWELL
3913 KOHRS	POWELL
3914 OVANDO	POWELL
3915 RACETRACK	POWELL
3916 SINCLAIR	POWELL
3917 BROWNS LAKE	POWELL
3918 PHOSPHATE	POWELL
3919 NEVADA CREEK DAM	POWELL
3920 HELENA YMCA CAMP	POWELL
3921 HELENA LIONS CAMP	POWELL
3922 GILBERT	POWELL

40

4001 BENZ	PRAIRIE
4002 BLATCHFORD	PRAIRIE

4003	CALYPSO	PRAIRIE
4004	FALLON	PRAIRIE
4005	KAMM	PRAIRIE
4006	MILDRED	PRAIRIE
4007	TERRY	PRAIRIE
4008	WHITNEY	PRAIRIE
4009	ZERO	PRAIRIE
4018	BLUFFPORT	PRAIRIE
4019	LACOMB	PRAIRIE
4020	CROW ROCK	PRAIRIE
4101	ALTA	RAVALLI
4102	CAMERON	RAVALLI
4103	CHARLOS HEIGHTS	RAVALLI
4104	CONNER	RAVALLI
4105	CORVALLIS	RAVALLI
4106	DARBY	RAVALLI
4107	FLORENCE	RAVALLI
4108	GRANTS DALE	RAVALLI
4109	HAMILTON	RAVALLI
4110	STEVENSVILLE	RAVALLI
4111	SULA	RAVALLI
4112	VICTOR	RAVALLI
4113	WOODSIDE	RAVALLI
4114	US 93 AT IDAHO LINE	RAVALLI
4116	SLEEPING CHILD HOT SPRINGS	RAVALLI
4117	MEDICINE SPRINGS	RAVALLI
4118	ROSEMONT	RAVALLI
4119	LAKE COMO	RAVALLI
4120	OLD FORT OWEN	RAVALLI
4201	ANDES	RICHLAND
4202	BURNS	RICHLAND

40

41

42

4203	CRANE	RICHLAND
4204	ENID	RICHLAND
4205	EPWORTH	RICHLAND
4206	FAIRVIEW	RICHLAND
4207	GETTYSBURG	RICHLAND
4208	GIRARD	RICHLAND
4209	JENKS	RICHLAND
4210	LAMBERT	RICHLAND
4211	LANE	RICHLAND
4212	NEWLON	RICHLAND
4213	NOHLY	RICHLAND
4214	RIDGELAWN	RICHLAND
4215	SAVAGE	RICHLAND
4216	SIDNEY	RICHLAND
4217	SIOUX PASS	RICHLAND
4218	MONT 20 AT ND LINE	RICHLAND
4219	MONT 23 AT ND LINE	RICHLAND
4220	RICHLAND CO FAIRGROUNDS	RICHLAND
4301	BAINVILLE	ROOSEVELT
4302	BLAIR	ROOSEVELT
4303	BROCKTON	ROOSEVELT
4304	CALAIS	ROOSEVELT
4305	CHELSEA	ROOSEVELT
4306	CULBERTSON	ROOSEVELT
4307	FORT KIPP	ROOSEVELT
4308	FROID	ROOSEVELT
4309	LAKESIDE	ROOSEVELT
4310	LANARK	ROOSEVELT
4311	MACON	ROOSEVELT
4312	MCCABE	ROOSEVELT
4313	POPLAR	ROOSEVELT

42

43

4314 SNOWDEN ROOSEVELT
4315 SPROLE ROOSEVELT
4316 WOLF POINT ROOSEVELT
4317 US 2 AT N DAK LINE ROOSEVELT
4318 STATE LINE CLUB ROOSEVELT
4319 BENRUD ROOSEVELT

4401 AHLES ROSEBUD
4402 ANGELA ROSEBUD
4403 ANTWERP ROSEBUD
4404 ASHLAND ROSEBUD
4405 BASCOM ROSEBUD
4406 BIRNEY ROSEBUD
4407 BIRNEY VILLAGE ROSEBUD
4408 BOWERS ROSEBUD
4409 CARTERSVILLE ROSEBUD
4410 COLDSPRINGS ROSEBUD
4411 COLSTRIP ROSEBUD
4413 FINCH ROSEBUD
4414 FLYNN ROSEBUD
4415 FORSYTH ROSEBUD

44
4416 GALBRAITH ROSEBUD
4417 HAMMOND ROSEBUD
4418 HATHAWAY ROSEBUD
4419 HIBBARD ROSEBUD
4420 HOWARD ROSEBUD
4421 INGOMAR ROSEBUD
4422 JOPPA ROSEBUD
4423 LAMEDEER ROSEBUD
4424 LANTRY ROSEBUD
4425 LOCK BLUFF ROSEBUD
4426 NICHOLS ROSEBUD

4427 RAHWAY ROSEBUD
4428 REA ROSEBUD
4429 ROCK SPRINGS ROSEBUD
4430 ROSEBUD ROSEBUD
4431 SUMATRA ROSEBUD
4432 THEBES ROSEBUD
4433 THURLOW ROSEBUD
4434 VANANDA ROSEBUD
4435 BRANDENBERG ROSEBUD
4436 LEE ROSEBUD
4437 CASTLE ROCK ROSEBUD
4438 VANSTEL ROSEBUD
4439 MAUDLIN ROSEBUD
4440 DAVIDELL ROSEBUD
4441 ORINOCO ROSEBUD

44
4501 AGENCY SANDERS
4502 BELKNAP SANDERS
4503 CAMAS SANDERS
4504 CAMAS PRAIRIE SANDERS
4505 DIXON SANDERS
4506 DONLAN SANDERS
4507 EDDY SANDERS
4508 HERON SANDERS
4509 HOT SPRINGS SANDERS
4510 KNOWLES SANDERS
4511 LONE PINE SANDERS
4512 MCDONALD SANDERS
4513 NIARADA SANDERS
4514 NOXON SANDERS
4515 PARADISE SANDERS
4516 PERMA SANDERS

4517 PLAINS	SANDERS
4518 QUINNS	SANDERS
4519 SNIDER	SANDERS
4520 THOMPSON FALLS	SANDERS
4521 TROUT CREEK	SANDERS
4522 TUSCOR	SANDERS
4523 WEEKSVILLE	SANDERS
4524 WHITE PINE	SANDERS
4525 US 10A AT IDAHO LINE	SANDERS
4526 CABINET GORGE DAM	SANDERS
4527 NOXON DAM	SANDERS
4528 FAS 471 AT IDAHO LINE	SANDERS
4529 NATIONAL BISON RANGE	SANDERS
4530 THOMPSON LAKES	SANDERS
4601 ANTELOPE	SHERIDAN
4602 ARCHER	SHERIDAN
4603 COALRIDGE	SHERIDAN
4604 COMERTOWN	SHERIDAN
4605 DAGMAR	SHERIDAN
4606 DALEVIEW	SHERIDAN
4607 DOOLEY	SHERIDAN
4608 HOMESTEAD	SHERIDAN
4609 MC ELROY	SHERIDAN
4610 MEDICINE LAKE	SHERIDAN
4611 OUTLOOK	SHERIDAN
4612 PLENTYWOOD	SHERIDAN
4613 RAYMOND	SHERIDAN
4614 REDSTONE	SHERIDAN
4615 RESERVE	SHERIDAN
4616 WESTBY	SHERIDAN
4617 FAS 256 PORT OF RAYMOND	SHERIDAN

45

46

46

4618 MONT 5 AT ND LINE

SHERIDAN

4701 BUTTE

SILVER BOW

4702 BUXTON

SILVER BOW

4703 DIVIDE

SILVER BOW

4705 DURANT

SILVER BOW

4706 FEELY

SILVER BOW

4707 FINLEN

SILVER BOW

4708 GREGSON

SILVER BOW

4709 HACKNEY

SILVER BOW

4710 HIGHVIEW

SILVER BOW

4711 JANNEY

SILVER BOW

4712 MELROSE

SILVER BOW

4713 NEWCOMBE

SILVER BOW

4714 NISSLER

SILVER BOW

4715 RAMSEY

SILVER BOW

47

4716 ROCKER

SILVER BOW

4717 SILVERBOW

SILVER BOW

4718 SKONES

SILVER BOW

4719 WALKERVILLE

SILVER BOW

4720 WOODIN

SILVER BOW

4721 CENTERVILLE

SILVER BOW

4722 MEADERVILLE

SILVER BOW

4723 COLUMBIA GARDENS

SILVER BOW

4724 QUINN

SILVER BOW

4725 BUTTE AIRPORT

SILVER BOW

4726 BUTTE COUNTRY CLUB

SILVER BOW

4727 VICTOR CHEMICAL PLANT

SILVER BOW

4801 ABSAROKEE

STILLWATER

4802 COLUMBUS

STILLWATER

48

4803 CRAVER

STILLWATER

4804 DEAN

STILLWATER

4805 FISHTAIL	STILLWATER
4806 LIMESTONE	STILLWATER
4807 MISKO	STILLWATER
4808 MOLT	STILLWATER
4809 NYE	STILLWATER
4810 ONEIDA	STILLWATER
4811 PARK CITY	STILLWATER
4812 RAPIDS	STILLWATER
4813 RAPELJE	STILLWATER
4814 REED POINT	STILLWATER
4815 WATAGA	STILLWATER
4816 WHEAT BASIN	STILLWATER
4817 YOUNGS POINT	STILLWATER
4818 BEEHIVE	STILLWATER
4819 MOUAT MINE	STILLWATER
4820 BENBOW MINE	STILLWATER
4821 MYSTIC LAKE	STILLWATER
<hr/>	
4901 BIG TIMBER	SWEETGRASS
4902 CARNEY	SWEETGRASS
4903 DEHART	SWEETGRASS
4904 GLASSTON	SWEETGRASS
4905 GREYCLIFF	SWEETGRASS
4906 MCLEOD	SWEETGRASS
4907 MELVILLE	SWEETGRASS
4908 QUEBEC	SWEETGRASS
4909 EATONS INN	SWEETGRASS
<hr/>	
5001 ACME	TETON
5002 AGAWAM	TETON
5003 BOLE	TETON
5004 BYNUM	TETON
5005 CHOTEAU	TETON

48

49

50

5006	CLAUDE	TETON
5007	CLEIV	TETON
5008	COLLINS	TETON
5009	CORDOVA	TETON
5010	DUTTON	TETON
5011	EASTHAM	TETON
5012	FAIRFIELD	TETON
5013	FARMINGTON	TETON
5014	FLUME	TETON
5015	KOYL	TETON
5016	PENDROY	TETON
5017	POWER	TETON
5018	BLACKLEAF	TETON
5019	PISHKUN BIRD REFUGE	TETON
5020	GIBSON DAM	TETON
5021	LOWRY	TETON
5022	GREENFIELDS LAKE	TETON
5023	BYNUM LAKE	TETON
5101	DEVON	TOOLE
5102	DUNKIRK	TOOLE
5103	ETHRIDGE	TOOLE
5104	FERDIG	TOOLE
5105	GALATA	TOOLE
5106	KEVIN	TOOLE
5107	OILMONT	TOOLE
5108	SHELBY	TOOLE
5109	SUNBURST	TOOLE
5110	SWEETGRASS	TOOLE
5111	US 91 PORT OF SWEETGRASS	TOOLE
5112	FOUR CORNERS	TOOLE
5113	GOLD BUTTE	TOOLE

50

51

5201	BIG HORN	TREASURE
5202	HYSHAM	TREASURE
5203	MYERS	TREASURE
5204	SANDERS	TREASURE
5301	BEAVERTON	VALLEY
5302	FORT PECK	VALLEY
5303	FORT PECK REC AREA	VALLEY
5304	FRAZER	VALLEY
5305	GLASGOW	VALLEY
5306	GLASGOW AIR BASE	VALLEY
5307	GLENTANA	VALLEY
5308	HINSDALE	VALLEY
5309	KINTYRE	VALLEY
5310	LARSLAN	VALLEY
5311	LUSTRE	VALLEY
5312	NASHUA	VALLEY
5313	OSWEGO	VALLEY
5314	OPHEIM	VALLEY
5315	PAISLEY	VALLEY
5316	RICHLAND	VALLEY
5317	TAMPICO	VALLEY
5318	THOENY	VALLEY
5319	VANDALIA	VALLEY
5320	WHATELY	VALLEY
5321	WHEELER	VALLEY
5322	FAS 247 PORT OF OPHEIM	VALLEY
5323	OPHEIM RADAR BASE	VALLEY
5324	WIOTA	VALLEY
5325	THE PINES REC AREA	VALLEY
5401	HARLOWTON	WHEATLAND
5402	HEDGESVILLE	WHEATLAND

53

54

52 Hedge 5/11/12
5403 JUDITH GAP

5404 NIHILL

5405 OKA

5406 OXFORD

5407 SHAWMUT ✓

54 5408 TWO DOT ✓

5409 VALENCIA

5410 WINNECOCK

5411 WRIGHT

5412 LEBO LAKE

5413 MARTINSDALE RESERVOIR

5501 BEAVERHILL

5502 CARLYLE

5503 SAINT PHILLIP

55 5504 WIBAUX

5505 YATES

5506 US 10 AT ND LINE

5601 ACTON

5602 BALLANTINE

5603 BILLINGS

5604 BROADVIEW

5605 COMANCHE

5606 CUSTER

56 5607 HESPER

5608 HUNTLEY

5609 LAUREL

5610 MOSSMAIN

5611 NIBBE

5612 POMPEYS PILLAR

5613 RIM ROCK

5614 SHEPHERD

WHEATLAND

WHEATLAND

WHEATLAND

WHEATLAND

WHEATLAND

WHEATLAND

WHEATLAND

WHEATLAND

WHEATLAND

WHEATLAND

WHEATLAND

WIBAUX

WIBAUX

WIBAUX

WIBAUX

WIBAUX

WIBAUX

YELLOWSTONE

YELLOWSTONE

YELLOWSTONE

YELLOWSTONE

YELLOWSTONE

YELLOWSTONE

YELLOWSTONE

YELLOWSTONE

YELLOWSTONE

YELLOWSTONE

YELLOWSTONE

YELLOWSTONE

YELLOWSTONE

YELLOWSTONE

56

5615 SHOREY	YELLOWSTONE
5616 WORDEN	YELLOWSTONE
5617 LOCKWOOD	YELLOWSTONE
5625 BILLINGS AIRPORT	YELLOWSTONE
5626 HUMBLE OIL REFINERY	YELLOWSTONE
5627 LAUREL OIL REFINERY	YELLOWSTONE
5701 APGAR VILLAGE	GLACIER PARK
5702 AVALANCHE	GLACIER PARK
5703 BOWMAN LAKE	GLACIER PARK
5704 CHIEF MOUNTAIN	GLACIER PARK
5705 KINTLA LAKE	GLACIER PARK
5706 LAKE MCDONALD	GLACIER PARK
5707 LAKE SHERBURNE	GLACIER PARK
5708 LOGAN PASS	GLACIER PARK
5709 MANY GLACIER	GLACIER PARK
5711 SAINT MARYS LAKE	GLACIER PARK
5712 QUARTZ	GLACIER PARK
5713 RISING SUN CAMP GROUND	GLACIER PARK
5714 SPRAGUE CAMP GROUND	GLACIER PARK
5715 SWIFTCURRENT	GLACIER PARK
5716 SPERRY CHALET	GLACIER PARK
5719 TWO MEDICINE	GLACIER PARK
5801 CANYON VILLAGE	YELLOWSTONE PARK
5802 FISHING BRIDGE	YELLOWSTONE PARK
5803 LAKE	YELLOWSTONE PARK
5804 MADISON JCT	YELLOWSTONE PARK
5805 NORRIS	YELLOWSTONE PARK
5806 OLD FAITHFUL	YELLOWSTONE PARK
5807 TOWER JCT	YELLOWSTONE PARK
5808 WEST THUMB	YELLOWSTONE PARK
5809 MAMMOTH HOT SPRINGS	YELLOWSTONE PARK

5810 YELLOWSTONE LAKE

YELLOWSTONE PARK

CONSTRUCTION TYPE CODE FOR HIGHWAY IMPROVEMENTS—Continued

(PPM-20-1)

Code		Type
Brick	Block	
		K. and L. Brick (K) or Block (L):
		Without bituminous wearing surface:
8301	8311	Non-rigid base
8706	8716	Old Portland cement concrete base
8707	8717	New Portland cement concrete base, non-reinforced
8708	8718	New Portland cement concrete base, reinforced
		With bituminous wearing surface less than 1" thick:
8321	8331	Non-rigid base
8726	8736	Old Portland cement concrete base
8727	8737	New Portland cement concrete base, non-reinforced
8728	8738	New Portland cement concrete base, reinforced
Digits 1 2 3 4		
		M. Combination type road:
9 - - -		The first digit (code "9") indicates combination type
9 0 - -		The second digit indicates one of the types comprising the combination type road
9 - 0 -		The third digit indicates the other type comprising the combination type road. The code used for digits 2 and 3 is as follows:
9 0 0 -		Graded and drained earth
9 1 1 -		Soil-surfaced
9 2 2 -		Gravel or stone
9 3 3 -		Bituminous surface-treated
9 4 4 -		Mixed bituminous
9 5 5 -		Bituminous penetration
9 6 6 -		Bituminous concrete, sheet asphalt or rock asphalt
9 7 7 -		Portland cement concrete
9 8 8 -		Brick or block
9 - - 0		The fourth digit indicates the predominating type of base:
9 - - 1		Graded and drained earth
9 - - 2		Soil-surfaced
9 - - 6		Gravel or stone
9 - - 7		Old Portland cement concrete
9 - - 8		New Portland cement concrete
9 - - 9		Old brick or block
		New brick or block
		X. Bridges (structures over 20 feet long)
X - - -		The first digit (code "X") indicates bridge classification
X 0 - -		The second digit indicates the nature of the structure:
X 1 - -		Highway over waterway
X 2 - -		Highway over railroad
X 3 - -		Highway over highway
X 4 - -		Highway over waterway and railroad
X 5 - -		Highway over waterway and highway
X 6 - -		Highway over railroad and highway
X 7 - -		Highway under railroad
X 8 - -		Highway under highway
X 9 - -		Highway under railroad and highway
		Other combinations, incl. highway over waterway, railroad and highway, also 3- and 4-level grade separations and miscellaneous.
		The third digit identifies the material of the principal supporting span-members of the span identified in column 4:
X - 0 -		Timber
X - 1 -		Masonry
X - 2 -		Concrete, not prestressed
X - 3 -		Steel
X - 4 -		Steel and concrete
X - 5 -		Timber and steel
X - 6 -		Timber and concrete
X - 7 -		Composite steel and concrete
X - 8 -		Concrete, prestressed
X - 9 -		Aluminum
		The fourth digit identifies the type of span (identifies main span type if the bridge comprises two or more span types):
X - - 0		Slab
X - - 1		Girder
X - - 2		Truss (except cantilever)
X - - 3		Rigid frame
X - - 4		Arch
X - - 5		Cantilever truss
X - - 6		Movable
X - - 7		Suspension
X - - 8		Box culvert (bridge length)
X999		Highway Tunnels

Code	Type
Y. Miscellaneous:	
Y002	Traffic signs
Y003	Landscaping (planting and related work)
Y004	All clearing (includes acquisition or removal of advertising signs, acquisition of property rights—junkyards, removal or relocation of junkyards).
Y005	Erosion control
Y006	Shoulder improvements
Y007	Minor structures (storm sewers, culverts, snowsheds, etc.)
Y008	Channelization
Y009	Pedestrian overpasses or underpasses
Y011	Railroad grade crossing protective device, flood lights
Y012	Railroad grade crossing protective device, flashing light
Y013	Railroad grade crossing protective device, automatic gates
Y014	Railroad grade crossing protective device, automatic barriers
Y015	Railroad grade crossing protective device, manually operated gates
Y016	Railroad grade crossing protective device, miscellaneous (crossbucks, advance warning, etc.)
Y017	Railroad grade crossing protective device, rotating stop disc signal
Y018	Railroad grade crossing protective device, flashing light with short arm gate
Y021	Safety rest areas and scenic overlooks
Y022	Comfort and convenience facilities
Y023	Screening unsightly areas (dumps, junkyards, etc.)
Y030	Highway lighting
Y031	Traffic signals
Y040	Railroad relocation
Y041	Special relocations (river channels, etc.)
Y050	Frontage roads
Y060	Utility adjustments handled as a construction item
Y070	Archaeological salvage
Y071	Paleontological salvage
Y101	Guardrail—delineator
Y102	Fencing
Y103	Striping
Y104	Removal of obstructions, including curbs
Y105	Improving horizontal or vertical sight distance
Y106	Flattening side slopes (other than for erosion control)
Y107	Curbs to control vehicle entrance and exit at roadside establishments
Work types identified by letters in lieu of code numbers:	
GM-G	Geodetic Markers (construction)
GM-H	Geodetic Markers (HPS, HPR or PR funds)
HPR	Highway Planning and Research (F.Y. 1964 and subsequent 1 1/2% funds)
HPS	Highway Planning and Research (F.Y. 1963 and prior 2% funds)
PR	Highway Planning and Research (1/2% ABC funds)
MAIN	Maintenance
PG	Post Construction (Forest highway funds)
PE	Preliminary Engineering
ROW	Right-of-way
R/WA	Acquisition of property owners' interests
R/WB	Relocation assistance—business
R/WP	Relocation assistance—families
R/WS	Acquisition of Scenic Land Strips outside highway right-of-way (Title 23, U.S. Code-Section 319)
R/WU	Utility work handled as a right-of-way item.

LEGEND FOR FOREST DEVELOPMENT TRANSPORTATION PLAN MAPS.

COLOR	SYMBOL	ROUTE DESIGNATION	JURISDICTION
BLUE		INTERSTATE HIGHWAY	PUBLIC ROAD AUTHORITY
BLUE		FEDERAL HIGHWAY	PUBLIC ROAD AUTHORITY
BLUE		STATE, COUNTY OR TOWN ROAD	PUBLIC ROAD AUTHORITY
BROWN		FOREST HIGHWAY	PUBLIC ROAD AUTHORITY
GREEN		FOREST DEVELOPMENT ROAD	FOREST SERVICE
BLUE		F.D. ROAD ON PUBLIC ROAD SYSTEM	PUBLIC ROAD AUTHORITY
BROWN		PRIVATE	PRIVATE
BLUE		OTHER FEDERAL AGENCIES ROAD	INDIAN, PARK SERVICE, BLM
BLACK		NON-EXISTING PLANNED ROAD	
		FOREST DEVELOPMENT TRAIL	FOREST SERVICE
CARLET		ALL PURPOSE TRAIL	FOREST SERVICE
BROWN		HIKER TRAIL	FOREST SERVICE
GREEN		F&L TRAIL	FOREST SERVICE
COLOR)		NON-EXISTING PLANNED TRAIL	

FOREST AIRFIELDS

BLUE		EXISTING PUBLIC AIRFIELD		ROAD OR TRAIL BRIDGE	
BROWN		USABLE PRIVATE AIRFIELD		PRIVATE LAND	
	<u>EXISTING</u>	<u>NON-EXISTING</u>			
GREEN			FOREST SERVICE AIRFIELD		TERMINI
GREEN			FOREST SERVICE HELIPORT		ROAD SECTION

TYPES OF BRIDGES

To aid in the uniform classification of bridges in the field and for the correct interpretation in the office, the following is submitted for use as a guide by the field parties.



QUEEN POST



KING POST



THROUGH-ARCH TRUSS



HOWE TRUSS



HOWE TRUSS



CONTINUOUS GIRDER

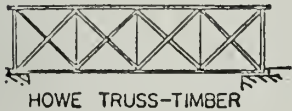

HOWE TRUSS-TIMBER

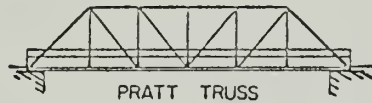

PRATT TRUSS



CANTILEVER

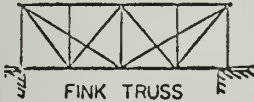

FINK TRUSS

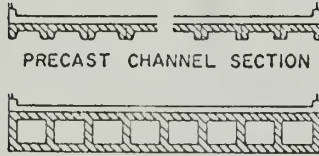

PRECAST CHANNEL SECTION

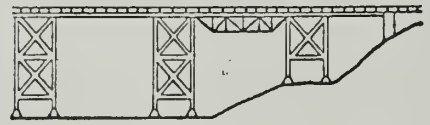

STEEL VIADUCT



PONY TRUSS



WARREN TRUSS



TIMBER TRESTLE

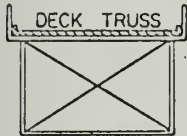

DECK TRUSS

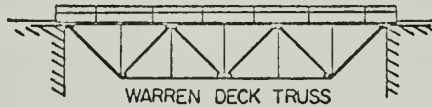

WARREN DECK TRUSS



RIGID FRAME-STEEL

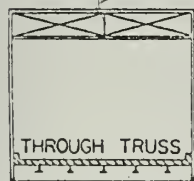

THROUGH TRUSS

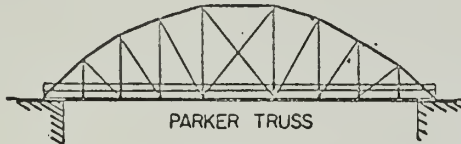

PARKER TRUSS

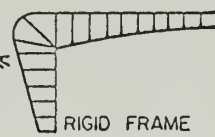

RIGID FRAME STEEL GIRDER ELEMENT

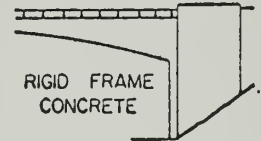

RIGID FRAME CONCRETE



SLAB SECTION

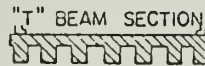

"I" BEAM SECTION

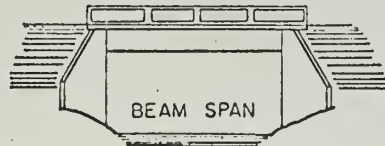

BEAM SPAN

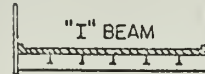

"I" BEAM

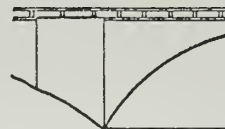

SPANDREL-FILLED ARCH

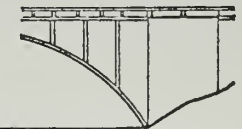

SPANDREL-OPEN ARCH



THROUGH GIRDER

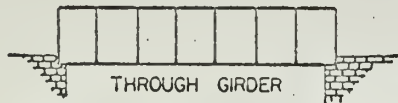

THROUGH GIRDER



DECK GIRDER

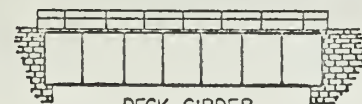

DECK GIRDER

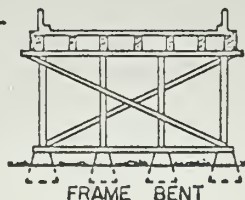

FRAME BENT

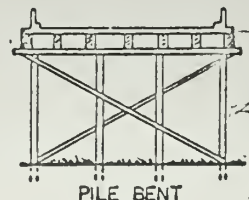

PILE BENT

